

J35F.1.S

Series of J35F.1.S-Enclosed type both side opening

JFLO[®]

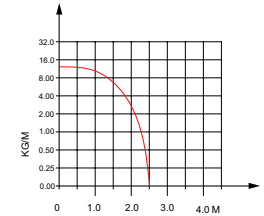
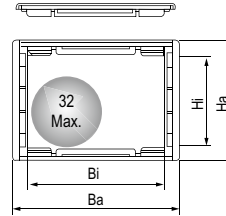

◎ Suitable for 32mm or less of cable.

Basic technical data

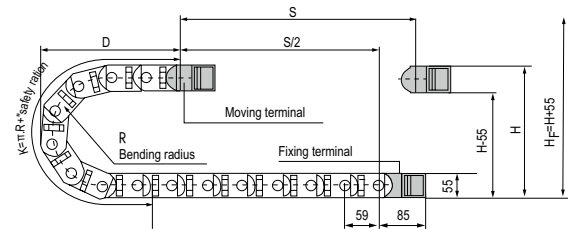

Pitch=59mm,link per meter=17,length of chain=S/2+K,S=stroke.K= π .R+ "safety ration"

| | | | | | | |
|---|-----|-----|-----|-----|-----|-----|
| R | 75 | 100 | 125 | 150 | 200 | 250 |
| H | 205 | 255 | 305 | 355 | 455 | 555 |
| D | 162 | 187 | 212 | 237 | 287 | 337 |
| K | 354 | 472 | 531 | 590 | 767 | 944 |

Actual mounting height:H_F=H+55mm(load 1.0kg/m)

Drawing

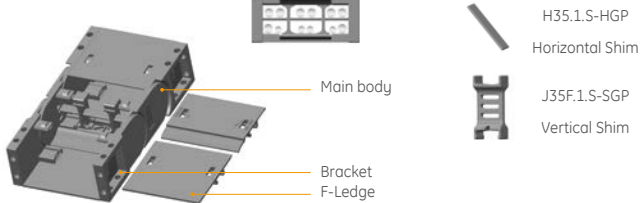

| Cable Chain No. | Hi | Bi | Ha | Ba | Styles | Bending radius R | Bracket type and parameters | | | | | | | | |
|-----------------|----|-----|----|-----|--------|--------------------------|-----------------------------|------------------|------------------|-----|----|----|----|-----|-----------------|
| | | | | | | | Applicable bracket type | Bore diameter Φ1 | mm hole distance | | | | | | Bracket No. |
| | | | | | | | | | A | B | C | D | E | F | |
| J35F.1.50S | 35 | 50 | 55 | 70 | F.S | 75,100, 125,150, 200,250 | F-F | 7.2 | 24 | 64 | 85 | 26 | 15 | 76 | J35F.1.50S-FJT |
| J35F.1.75S | 35 | 75 | 55 | 95 | F.S | | F-F | 7.2 | 24 | 89 | 85 | 26 | 15 | 101 | J35F.1.75S-FJT |
| J35F.1.100S | 35 | 100 | 55 | 120 | F.S | | F-F | 7.2 | 24 | 114 | 85 | 26 | 15 | 126 | J35F.1.100S-FJT |
| J35F.1.125S | 35 | 125 | 55 | 145 | F.S | | F-F | 7.2 | 24 | 139 | 85 | 26 | 15 | 151 | J35F.1.125S-FJT |
| J35F.1.150S | 35 | 150 | 55 | 170 | F.S | | F-F | 7.2 | 24 | 164 | 85 | 26 | 15 | 176 | J35F.1.150S-FJT |

unit: mm

Note: S indicates that the both side open,F indicates that the Enclosed

Fix bracket type and parameters (See table)

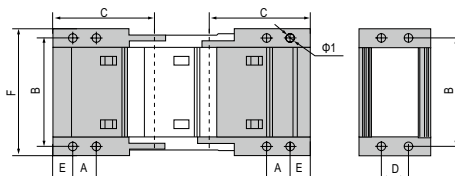

F-F type bracket

Order Example

Sample: inner height 35mm, inner width 50mm, radius 75mm, length 17 links/1 meter

Chain J35F.1.50S R75 1000mm /17 Links

Bracket J35F.1.50S -XJT 1 Set

Accessories 1 vertical shim/1 horizontal shim can be mounted in every link

Note: Various sizes can be customized according to customer requirements.