

JN15Q.1.W

Series of JN15Q.1.W-Bridge type exterior opening

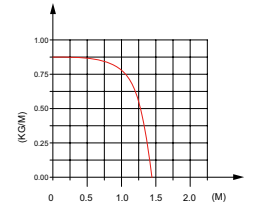
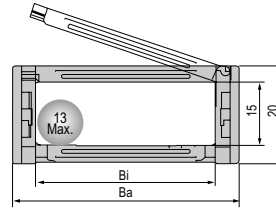

◎ Suitable for 13mm or less of cable.

Basic technical data

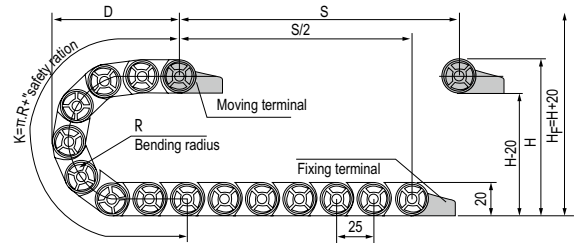

Pitch=25mm, link per meter=40, length of chain=S/2+K, S=stroke. $K = \pi \cdot R + \text{"safety ratio"}$

R	28	38	48
H	76	96	116
D	63	73	83
K	150	175	225

Actual mounting height: $H_f = H + 20\text{mm}$ (load 0.75kg/m)

Drawing

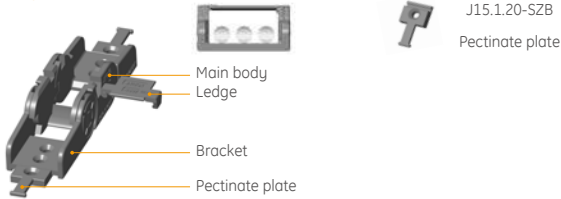

Cable Chain No.	Hi	Bi	Ha	Ba	Styles	Bending radius R	Bracket type and parameters								
							Applicable bracket type	Bore diameter $\phi 1$	(mm) hole distance						Bracket No.
									A	B	C	D	E	F	
JN15Q.1.15W	15	15	20	25	Q.W	28,38,48	X ₁	3.2*4.2L	8	32	7	25	JN15Q.1.15W-XJT		
JN15Q.1.20W	15	20	20	30	Q.W		X ₁	3.2*4.2L	8	32	7	30	JN15Q.1.20W-XJT		
JN15Q.1.30W	15	30	20	40	Q.W		X ₂	4.2*5.2L	15	32	7	40	JN15Q.1.30W-XJT		
JN15Q.1.40W	15	40	20	50	Q.W		X ₃	3.2*4.2L	8	32	7	50	JN15Q.1.40W-XJT		
JN15Q.1.50W	15	50	20	60	Q.W		X ₃	3.2*4.2L	8	42	7	60	JN15Q.1.50W-XJT		

unit: mm

Note: Q.W Bridge type exterior opening, X: oblique bracket, Different serial number indicates the difference rank type of fixing holes

Fix bracket type and parameters (See table)

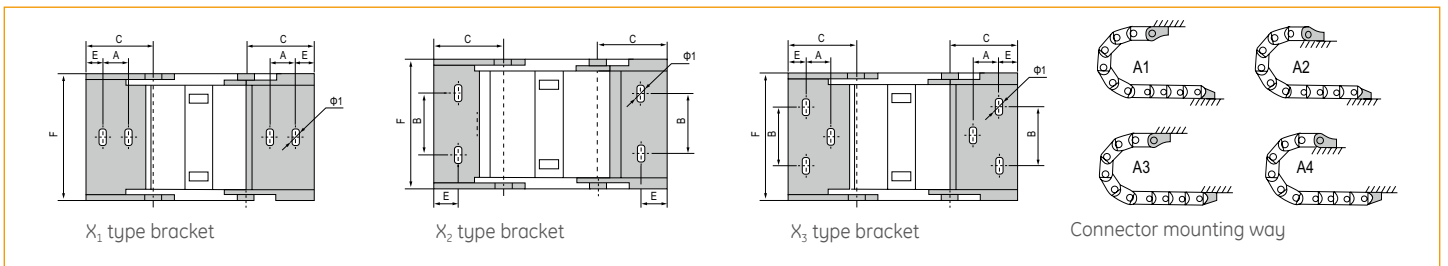

Order Example

Sample: inner height 15mm, inner width 15mm, radius 28mm, length 20 links/0.5 meter

Chain JN15Q.1.15W R28 500mm /20 Links (Physical length: ± 2mm)

Bracket JN15Q.1.15W-XJT 1 (Set)

Accessories